

# AVAILABLE

- 4 Building Complex
- Buildings Finished to Your Company's Specifications
- Building 1: 31,500 SqFt
- Building 2: 31,500 SqFt
- Building 3: 31,500 SqFt
- Building 4: 23,100 SqFt
- Office to Suit
- 22' Ceiling Heights
- Multiple Dock Doors
- Multiple Grade Doors
- 50' x 50' Column Spacing
- High End Images
- Radiant Heat

## Northline Industrial Development



**For Additional Information**

**Contact:**

**Randall Allman**

randall.allman@grubb-ellis.com

**Or**

**Jim McClowry**

james.mcclowry@grubb-ellis.com

**248.350.9500**

**www.grubb-ellis.com**

Transactions • Management Services • Consulting Services



**Grubb & Ellis**

Property Solutions Worldwide

Grubb & Ellis Company

26555 Evergreen, Suite 500 • Southfield, MI 48076 • 248.350.9500 • Fax 248.357.0923 • www.grubb-ellis.com

*This statement with the information it contains is given with the understanding that all negotiations relating to the purchase, renting or leasing of the property described above shall be conducted through this office. The above information, while not guaranteed, has been secured from sources we believe to be reliable.*

# 4 New Industrial Buildings

Property Solutions Worldwide

**Grubb&Ellis**

Property Solutions Worldwide

**Grubb&Ellis**

Property Solutions Worldwide

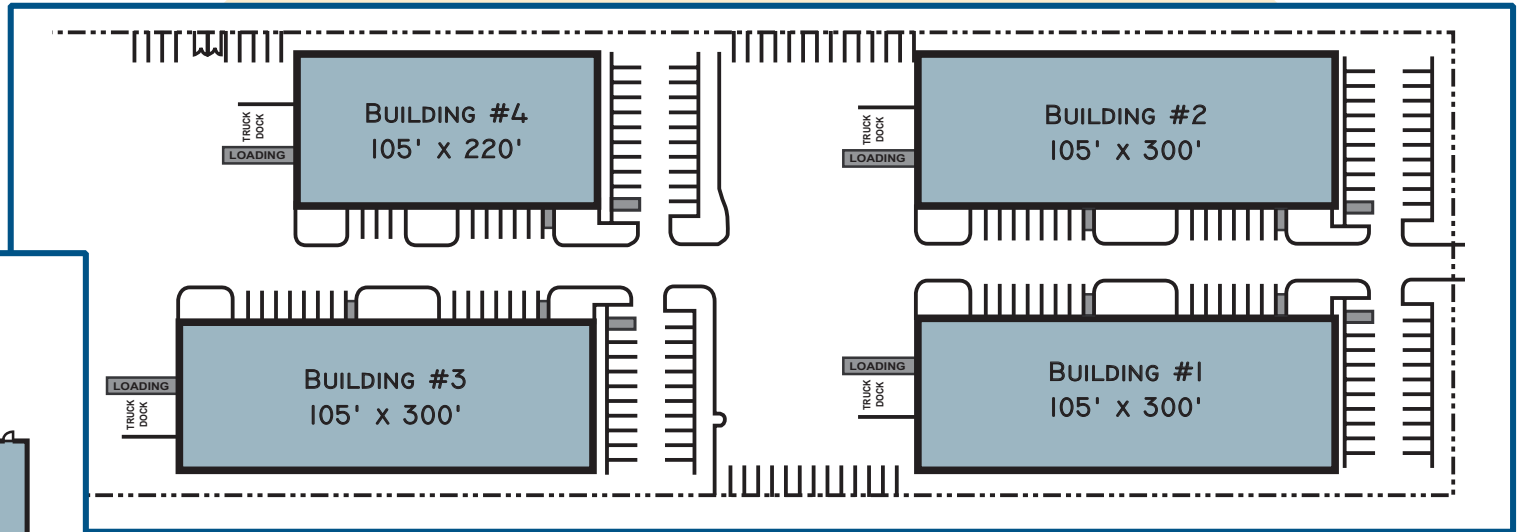
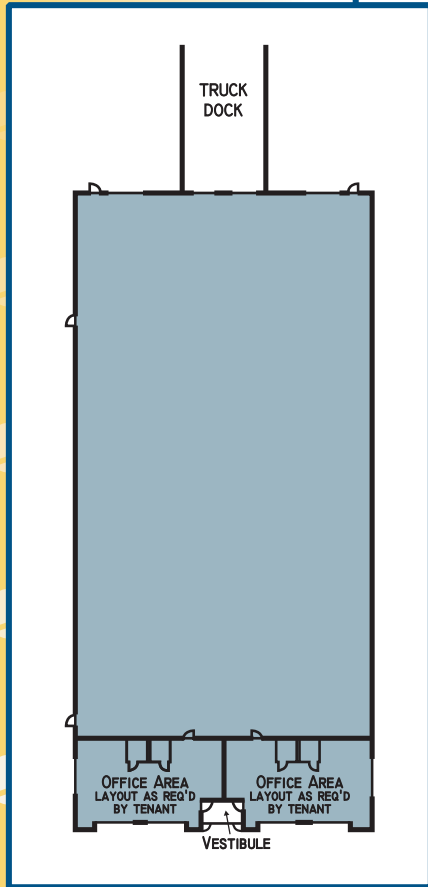

***For Additional Information***

**Contact:**

**Randall Allman**

[randall.allman@grubb-ellis.com](mailto:randall.allman@grubb-ellis.com)

**Or**

**Jim McClowry**

[james.mcclowry@grubb-ellis.com](mailto:james.mcclowry@grubb-ellis.com)

**248.350.9500**

[www.grubb-ellis.com](http://www.grubb-ellis.com)

Transactions • Management Services • Consulting Services

**Grubb&Ellis**  
Property Solutions Worldwide

**Grubb&Ellis**  
Property Solutions Worldwide